

XYZ axis | N31.XY100Z25E

Three-axis Linear Piezo Motor with Sensor

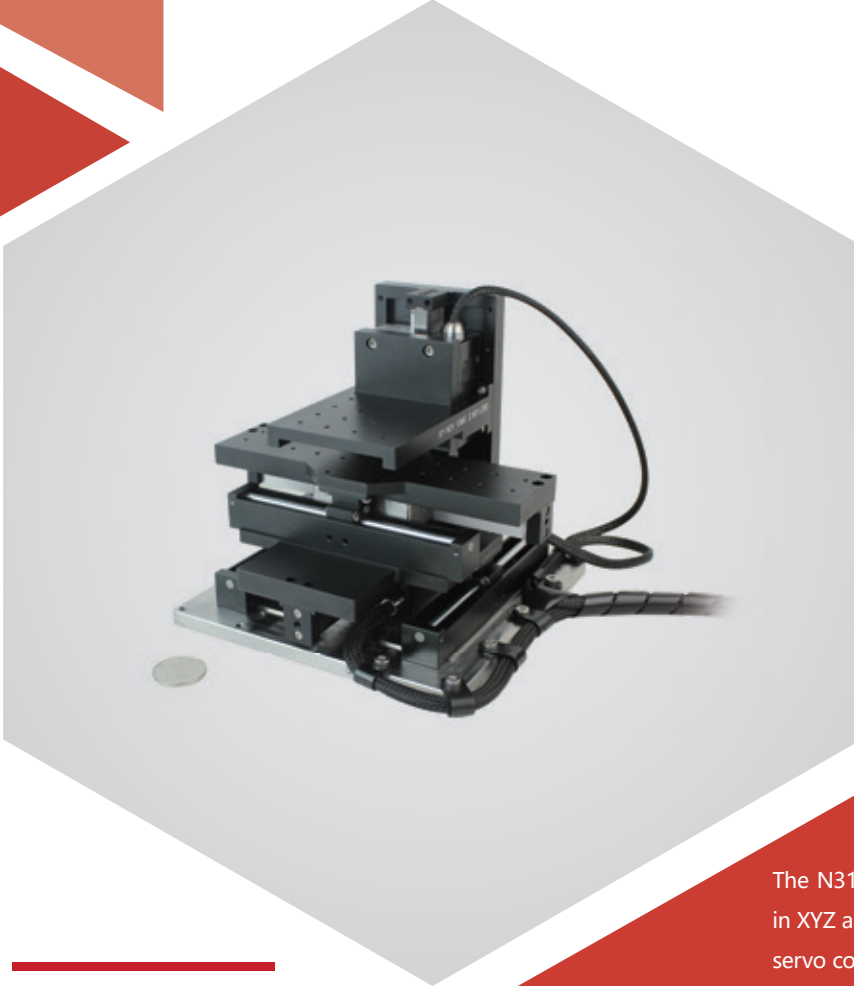

Characteristics >>

- Nanoscale resolution
- Load capacity up to 2.5kg
- Optional 25, 50 or 100mm travel per axis
- With incremental encoder

Applications >>

- Sample movement of super-resolution imaging
- Large range electron beam direct writing (EBL)
- Integrated circuit manufacturing and testing
- Micro-nano equipment and manufacturing
- Nano-focusing and scanning
- Microscopic and nano-CT
- Sample manipulation of scanning electron microscopy (SEM)
- Precision alignment and orientation of high vacuum samples

Introduction

The N31 series three-axis linear piezo motor can move in XYZ and is equipped with an incremental encoder for servo control. It adopts PZT piezo drive and can achieve nanoscale resolution. The stroke for each axis can be selected 25, 50, 100mm.



Harbin Core Tomorrow Science & Technology Co., Ltd.

Tel: +86-451-86268790

Email: info@coremorrow.com

Headquarters: Building I2, No.191 Xuefu Road, Nangang District, Harbin

Fax: +86-451-86267847

Web: www.coremorrow.com

Shanghai Office: Building 2, No.608 Shengxia Road, Pudong District, Shanghai

Technical Data >>

Type	N31.XY100Z25E	Units
Active axes	X Y Z	
Integrated sensor	incremental encoder	
Nominal travel range	XY±50, Z±12.5	mm
Max speed	2.5	mm/s
Resolution	80	nm
Bidirectional Repeatability	3	µm
Load capacity	2.5	kg
Operating temperature	0~40	°C
Mass(excluding cable)	5.3	kg±5%
Material	Aluminium, steel	
Cable length	1.5	m±10mm
Recommended controller	E71.D4E-H	

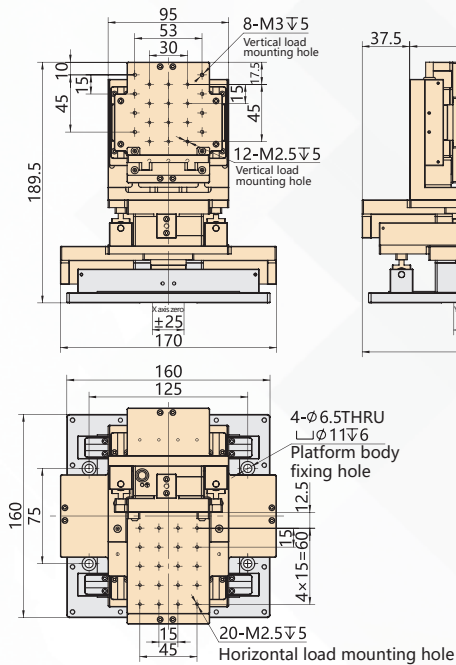
Drawing >>

Recommended Controller >>

E71.D4E-H
 3 or 4 channels output, digital control
 USB, RS-422, RS-232 communication
 Ave.current to 75mA



Harbin Core Tomorrow Science & Technology Co., Ltd.

Tel: +86-451-86268790 Email: info@coremorrow.com
 Fax: +86-451-86267847 Web: www.coremorrow.com

Headquarters: Building I2, No.191 Xuefu Road, Nangang District, Harbin
 Shanghai Office: Building 2, No.608 Shengxia Road, Pudong District, Shanghai